

A HOST OF BENEFITS  
FOR A GREENER LIVING

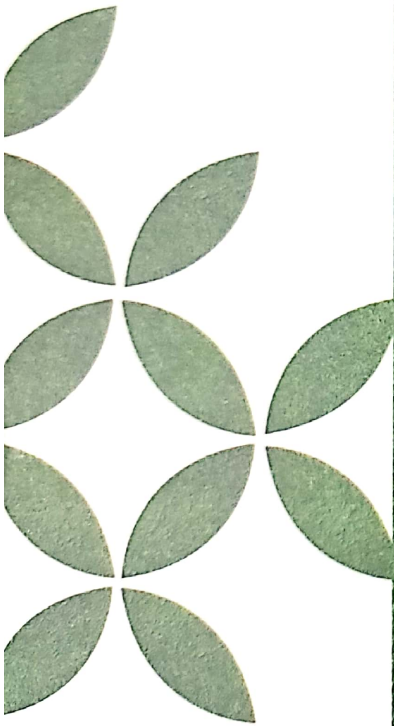

**2, 3 & 4 BHK**

Luxury Apartment @ Tirumala shivapuri, Kapra, Hyderabad.



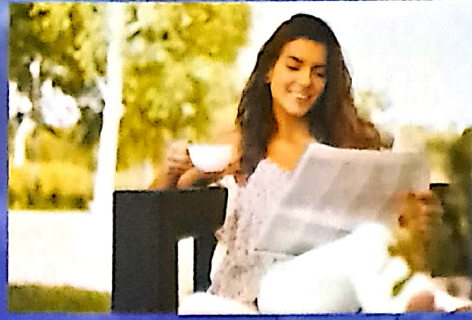

Create With The Heart  
Build With The Mind



# TYPICAL Floor Plan

## AREA STATEMENT

Flat No.	1	2	3	4	5	6
Type	2 BHK	2 BHK	2 BHK	3 BHK	2 BHK	3 BHK
Facing	West	West	West	East	East	East
Area (sft)	1200	1200	1200	1650	1200	1600

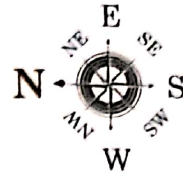

## BLOCK A

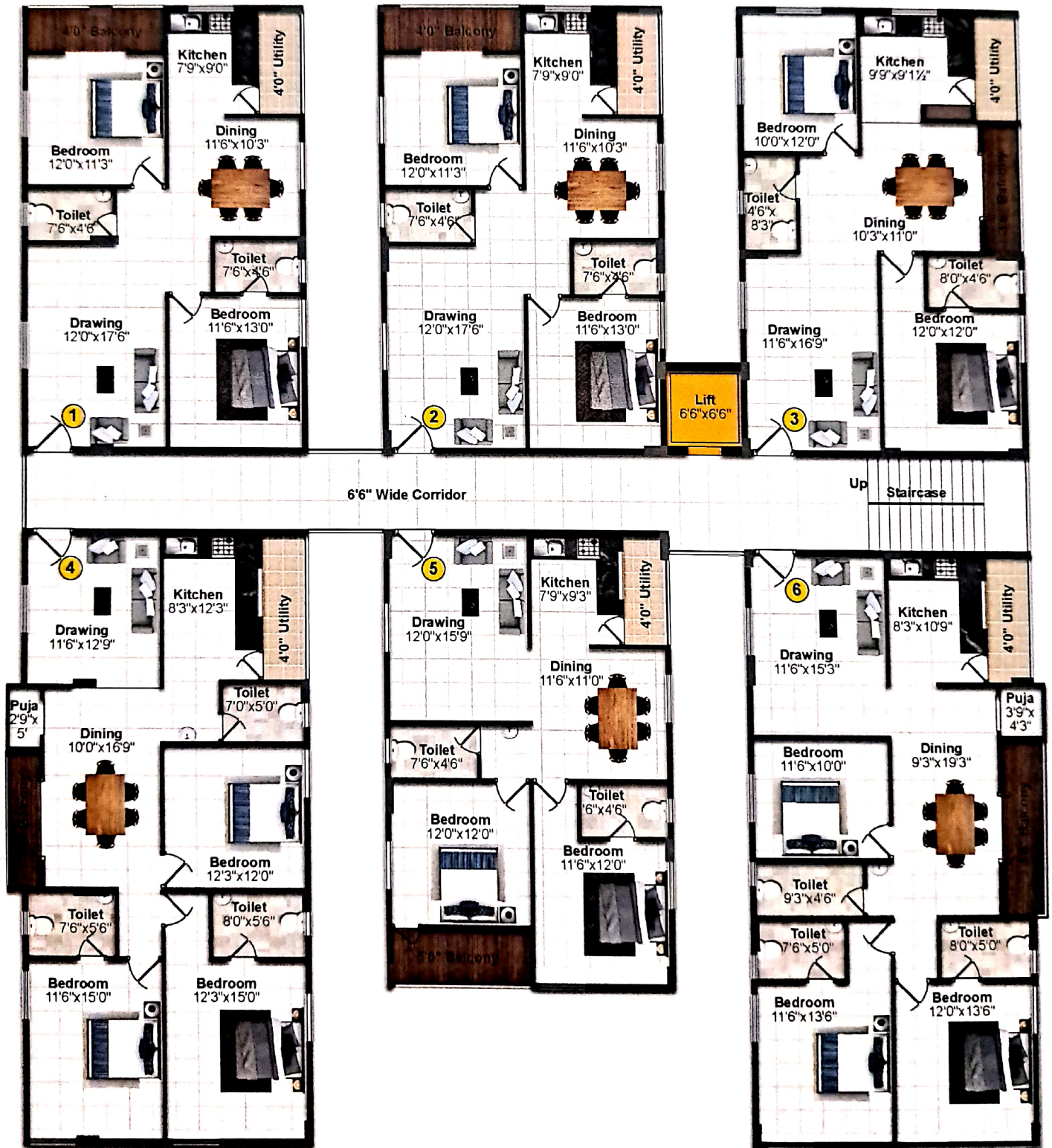



# KEY Plan

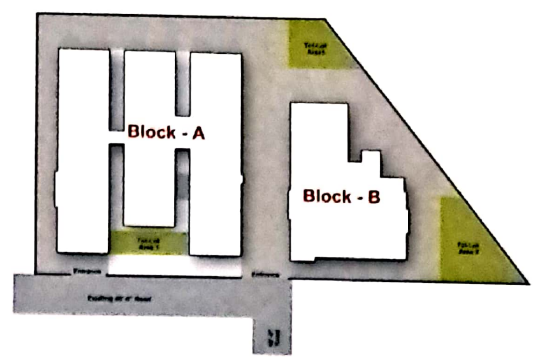

## AREA STATEMENT

Flat No.	1	2
Type	2 BHK	4 BHK
Facing	West	East
Area (sft)	1250	2335

## BLOCK B



## Amenities & Features

- Strategic location
- GHMC Approved project
- 2, 3 & 4 BHK Flats
- 1200 Sft to 2335 Sft areas
- 40 Luxurious apartments
- Premium quality construction
- 100% Vasthu
- Excellent ventilation
- Individual flats, no common walls
- CCTV facility
- Exquisite landscaping
- Ample car parking
- Municipal Water
- Children's Play area
- 24 / 7 Security
- 24 / 7 Water Supply
- Intercom
- Rain water harvesting
- Power backup generator in common areas

- Club house
- Outdoor Gym
- Landscape parks with exclusive childrens park
- Swimming Pool

**CLUB HOUSE MEMBERSHIP COST EXTRA**





 **STRUCTURE**  
RCC Framed Structure.

 **WALLS**  
9" Thick outer and 4½" thick inner country brick walls with cement mortar (1:6).

 **PLASTERING**  
Plastering with sponge finish in cement mortar.

 **FLOORING**  
24"X24" Vitrified tiles flooring for hall, drawing, dining, bedrooms and kitchen.

 **PAINTING**  
Luppam finishing in hall, drawing, dining and bedrooms with tractor emulsion, ACE for external walls of asian paints. Enamel paint for doors and grills.

 **KITCHEN**  
Black granite top with steel sink for the kitchen platform. Glazed tile dado upto 2' height above kitchen platform.

 **TOILETS**  
Ceramic tile flooring of standard make in all toilets and glazed tile dado upto door height. Wall mixers with showers in toilets standard make. European WC's are of hindware / Cera make, wash basin in dining hall. PVC pipes for sewerage lines of standard make, CPVC pipes for all inlet & External water lines.

 **WATER SUPPLY**  
Bore well water from overhead tank, Municipal drinking water point in kitchen from overhead tank.

## SPECIFICATIONS

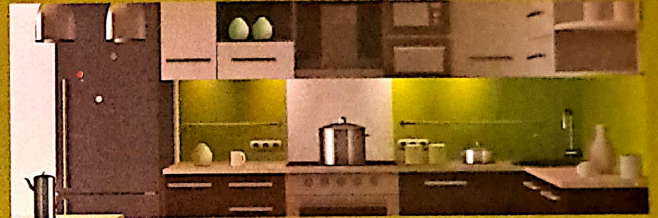

 **TELEPHONE & CABLE**  
TV points in hall and bedrooms, Provision for telephone & internet.

 **DOORS**  
All door frames are of teak wood, Main door shutter is of teak wood with polish, all other door shutters are moulded doors.

 **WINDOWS**  
UPVC windows with safety grills.

 **ELECTRICAL**  
Concealed copper wiring with adequate points in all rooms. A.C. Points and two way switches will be provided in bedrooms. Modular switch board of standard make for electrical points, 3 Phase power supply.

 **LIFT**  
Lift of 6 passengers capacity. (Johnson / Kone)

 **GENERATOR**  
Backup for lift, borewell, common lighting.

 **NOTE**  
1) Registration Charges, GST applicable as per Govt. norms to be borne by the customers only.  
2) Persons desirous to alter / modify their flat by prior request and additional payment to be borne by the customers only.  
3) Cement racks, arch, etc optional with extra cost.  
4) Amenities charges to be borne by customers only.

SOME OF  
OUR PROJECTS



Tirumala Sai Heights  
@ Boduppal.

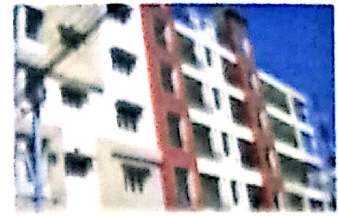

Tirumala Ramleela Residency  
@ RK puram, Kothapet.

## LOCATION MAP

(Not to scale)

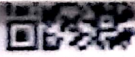
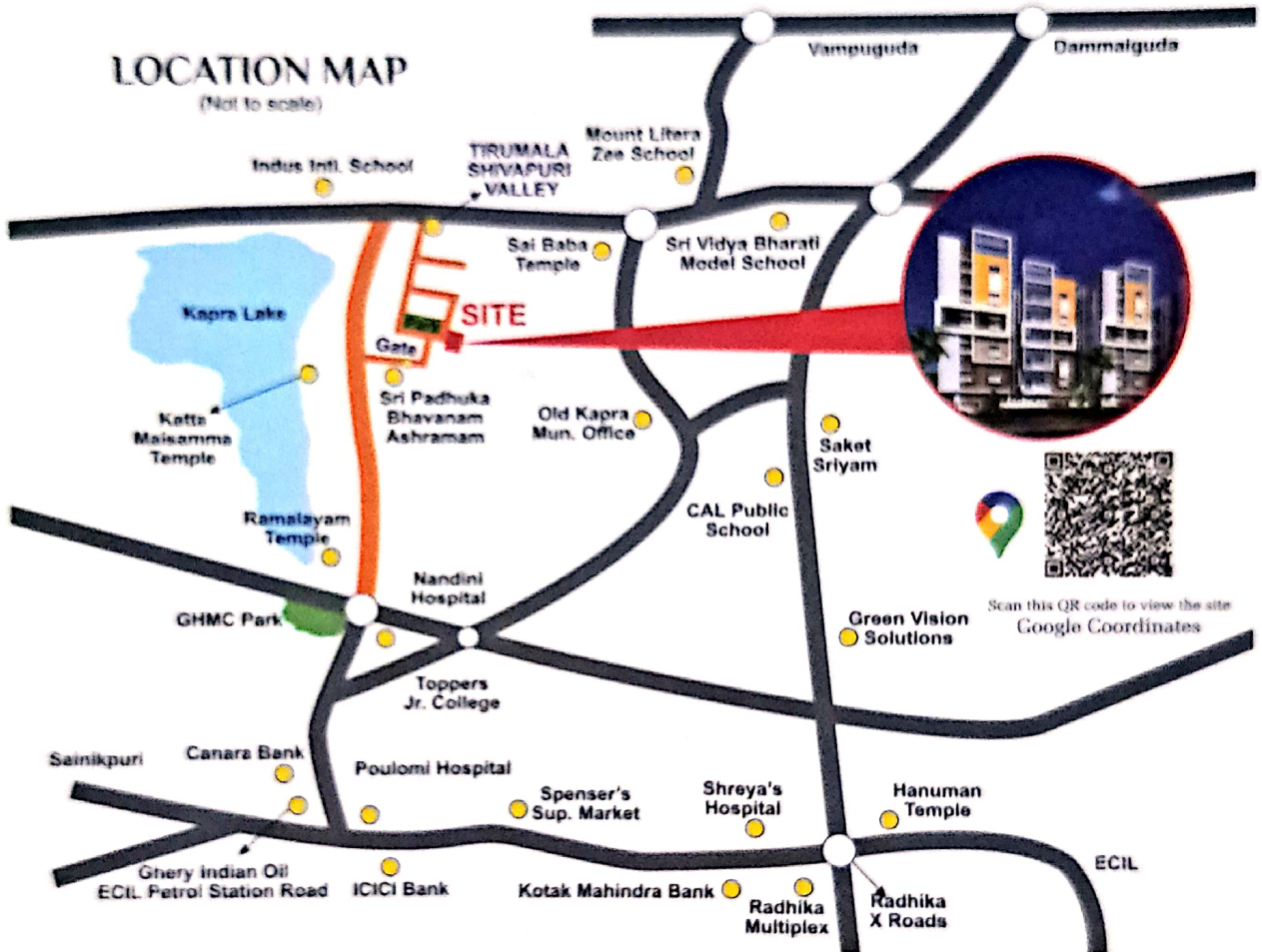

To get directions to the site  
use Google Map

A Project by



# TIRUMALA HOMES

Private Limited

G 2, Tirumala Pride, Main Road, Malakpet, Hyderabad - 500 036.

Contact Us : 98493 60061, 98499 87077, [REDACTED]

**NOTE :** This brochure is only a conceptual presentation of the project and not a legal offering. The promoters reserve the right to make changes in plans, specifications and elevation as deemed fit.

**DISCLAIMER :** Disclaimer The information provided in the brochure (including any images, brochures, plans etc) is for informational purposes only and you shall not rely or depend on such information for the purpose of making any purchase in any of our projects. The information in the brochure does not constitute an invitation to purchase, advertisement, marketing or offer for sale of any of the units in our projects. We will be taking steps for registration of the project in accordance with the Real Estate Regulation Authority Act, 2016 as soon as the authority is constituted.



Scanned with OKEN Scanner